

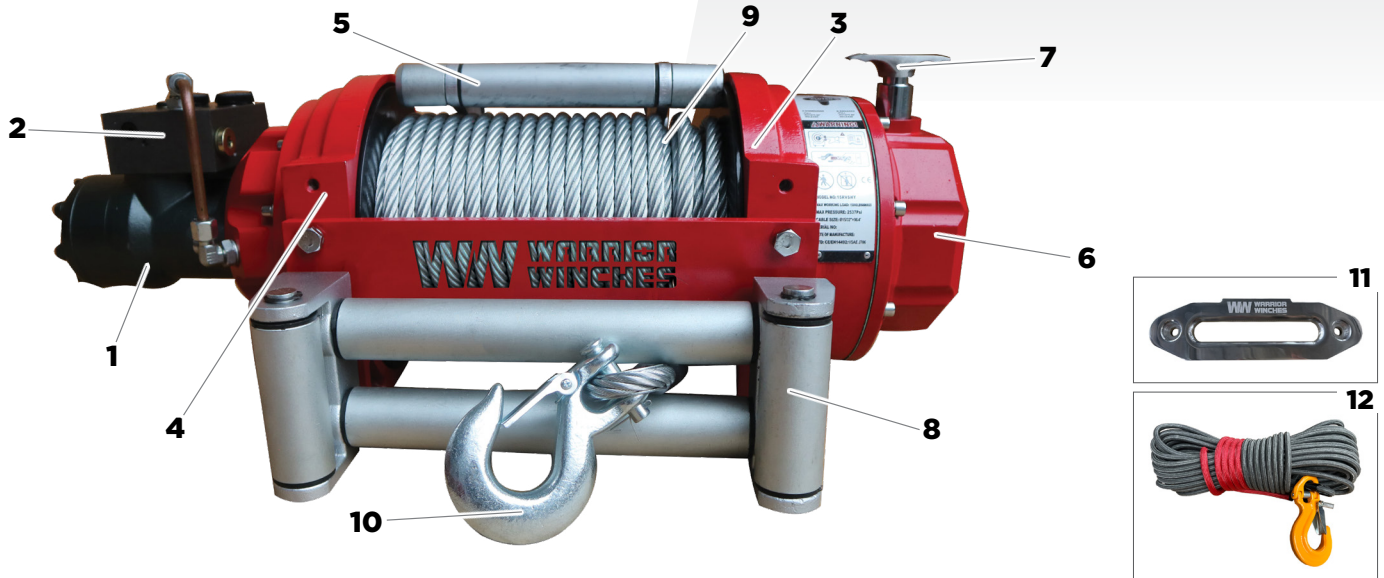



WW WARRIOR WINCHES INDUSTRIAL

- 🔑 **MODEL** / 18RVSHY-CAD
18RVAHY-CAD
- ⚡ **MOTOR TYPE** / Hydraulic 12.2 ci (200cc)
- ★ **CERTIFICATION** / SAEJ-706



Ref:	Description:	SKU:
1	Hydraulic Motor	HV1500100-2
2	Balance Valve	BAL002
3	End Bearing	HV1500032
4	Motor Bracket	HV1500020
5	Tensioner	TEN15/18RV
6	Gearbox	GBT18RVSHY
7	Clutch Assembly	HV1000500
8	Roller Fairlead	RF15/18RV
9	Cable with Hook	WIR18RV
10	Hook	GHK005T-CAD
11	Fairlead (for Synthetic Rope)	ALIRV10-CAD
12	0.55" x 65.6' Synthetic Rope and Hook	14AEMU/20-CAD

WW WARRIOR WINCHES INDUSTRIAL

-  **MODEL** / 18RVSHY-CAD
18RVAHY-CAD
-  **MOTOR TYPE** / Hydraulic 12.2 ci (200cc)
-  **CERTIFICATION** / SAEJ-706

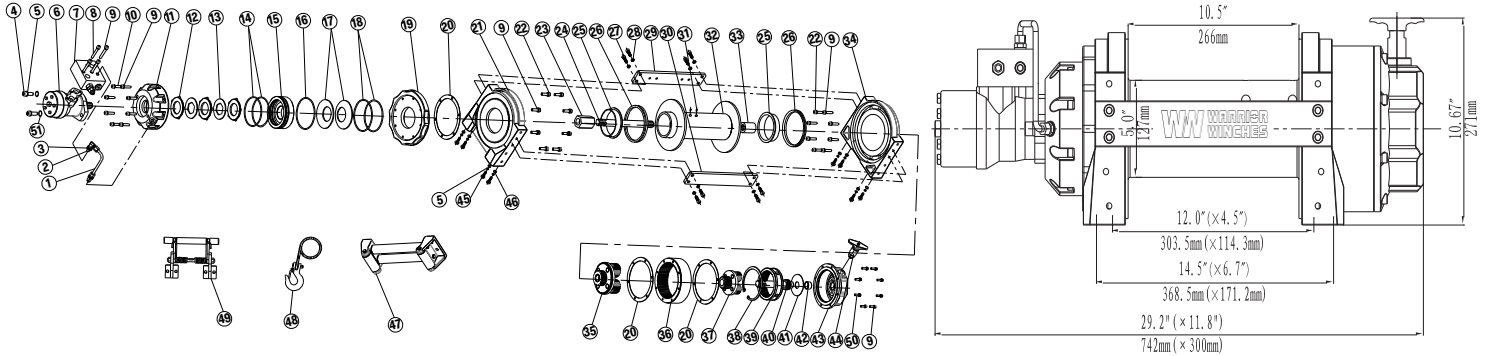

#	Part Number	Description	Qty.
1	HV1500001	High-pressure oil tube	1
2	HV1500002	Oil connection Oil	2
3	HV1500003	Combination Washer 14	2
4	HV1500004	Cap Screw M12 x 35	2
5	HV1500005	Lock Washer Φ12	10
6	HV1500100-2	Hydraulic Motor	1
7	HV1500006	Blanced valve	1
8	HV1500007	Cap Screw M8 x 55	4
9	HV1500008	Lock Washer Φ8	38
10	HV1500009	Screw M8 x 25	8
11	HV1500010	Brake stents	1
12	HV1500011	Brake block	3
13	HV1500012	Friction plate	2
14	HV1500013	O-ring seal 100*3.55	2
15	HV1500014	Piston	1
16	HV1500015	O-ring seal 140*2.65	1
17	HV1500016	Disk spring	2
18	HV1500017	O-ring seal 115*3.55	2
19	HV1500018	Motor mounting plate	1
20	HV1500019	Gasket	3
21	HV1500020	Motor bracket	1
22	HV1500021	Screw M8 x 35	18
23	HV1500022	Coupling	1
24	HV1500023	Transmission shaft	1
25	HV1500024	Bearing bush	2
26	HV1500025	Ring Seals	2

#	Part Number	Description	Qty.
27	HV1500026	Screw M10 x 25	8
28	HV1500027	Lock Washer Φ10	8
29	HV1500028	Stand bar(a)	1
30	HV1500029	Stand bar(b)	1
31	HV1500030	Screw M8 x 15	2
32	HV1500200-2	Drum Assembly	1
33	HV1500031	Coupling (1)	1
34	HV1500032	End Bearing	1
35	HV1500300	Gear Carrier Assembly (Output)	1
36	HV1500033	Gear-Ring (Output)	1
37	HV1500400	Gear Carrier Assembly (Input)	1
38	HV1500034	Circlip for hole Φ150	1
39	HV1500035	Gear-Ring (Input)	1
40	HV1500036	Gear-Input Sun	1
41	HV1500037	Trust Washer	1
42	HV1500038	Axle sleeve	1
43	HV1500039	Cover-Gear Housing	1
44	HV1500500	Clutch Assembly	1
45	HV1500040	Screw M12 x 30	8
46	HV1500041	Think Flat Washer Φ12	8
47	HV1500600	Roller Fairlead	1
48	HV1500700-2	Cable Assembly	1
49	HV1500800	Tensioned Of Steel Wire Supplied Assembly	1
50	HV1500042	Screw M8 x 30	8
51	HV1500043	Think Flat Washer	2